



Installation Instructions:

(Part # S/B61270W)

Engine Skid plate

2021+ BRONCO 2dr&4dr

NOTE: Carefully read entire instructions thoroughly before attempting to install this part.

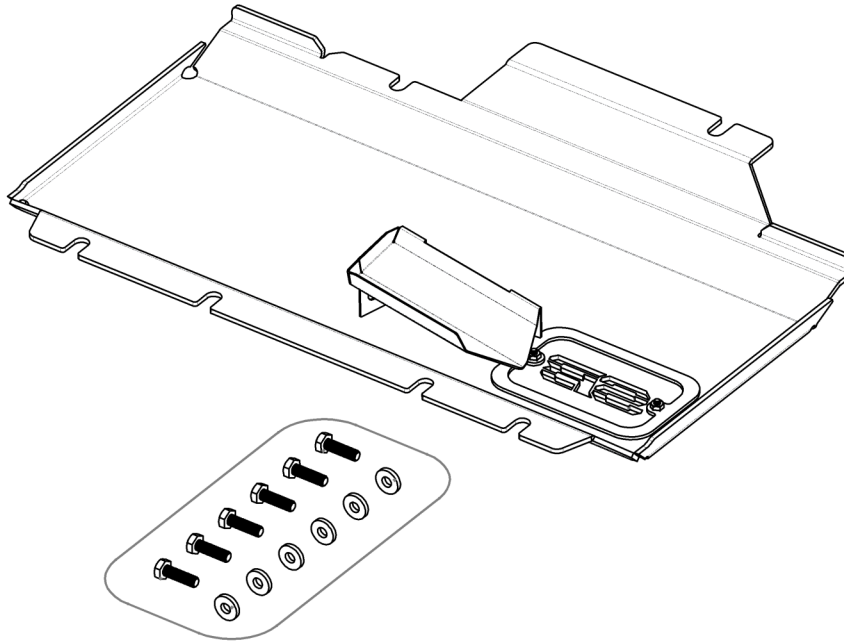

Parts Included	Qty	ID
S/B61270-01 ENGINE SKID PLATE	1	1
S/B61270-05 PANEL COVER	1	2

Hardware Pack S/B61270W-06	Qty
M10x1.5x25 HEX BOLT GR10.9	6
M10 FLAT WASHER ZINC	6
M6X1.0X16 FLAT HEAD SCREW	2

SUGGESTED TOOLS:

- General mechanic tool set with Allen & Torx head drivers
- Torque wrench



For Technical Support/Warranty Information please call 800-776-0767 EXT 1317

Smittybilt, 400 W Artesia, Compton, CA 90220



Installation Instructions:

(Part # S/B61270W)
Engine Skid plate
2021+ BRONCO 2dr&4dr

INSTALLATION:

Step 1: Read through these instructions thoroughly prior to starting the install. Use masking tape to protect painted surfaces.

NOTE: Make sure vehicle is raised safely on a hoist, or parked on flat level ground with all 4 wheels chocked.

Step 2: Carefully remove the front skid plate and set aside. Carefully loosen and remove the remaining two bolts on the second crossmember and remove OE engine skid plate (Fig A.)

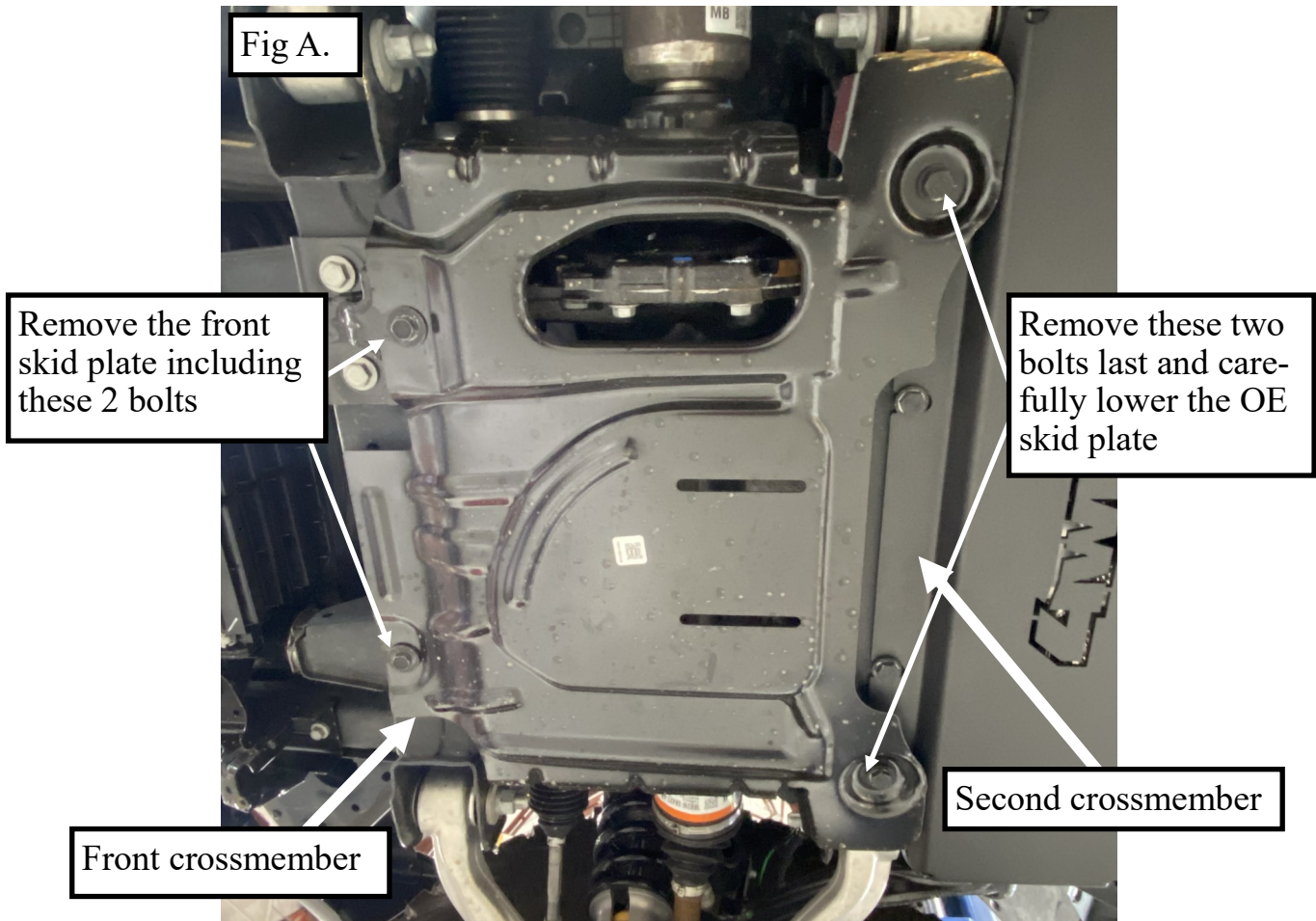

For Technical Support/Warranty Information please call 800-776-0767 EXT 1317

Smittybilt, 400 W Artesia, Compton, CA 90220



Installation Instructions:

(Part # S/B61270W)

Engine Skid plate

2021+ BRONCO 2dr&4dr

.NOTE: For 'Stand Alone' install, proceed to **Step 4**.

Step 3: If you already have S/Bs Transmission skid-plate S/B61271W installed, loosen the remaining two mounting bolts and install this skid plate over the top, sandwiching the transmission skid against the second crossmember. **(Fig B.)**

Step 4: Do not re-use the OE mounting bolts! Using the M10x1.5x25mm bolts and washers provided, loosely install a bolt and washer in the outer mounting holes of the second crossmember. Check the orientation and slide your new skid plate into position. Install two more bolts and washers in the front crossmember mounting holes. Double check fitment, install the remaining two bolts and washers in the second crossmember and tighten just snug. **(Fig B.)**

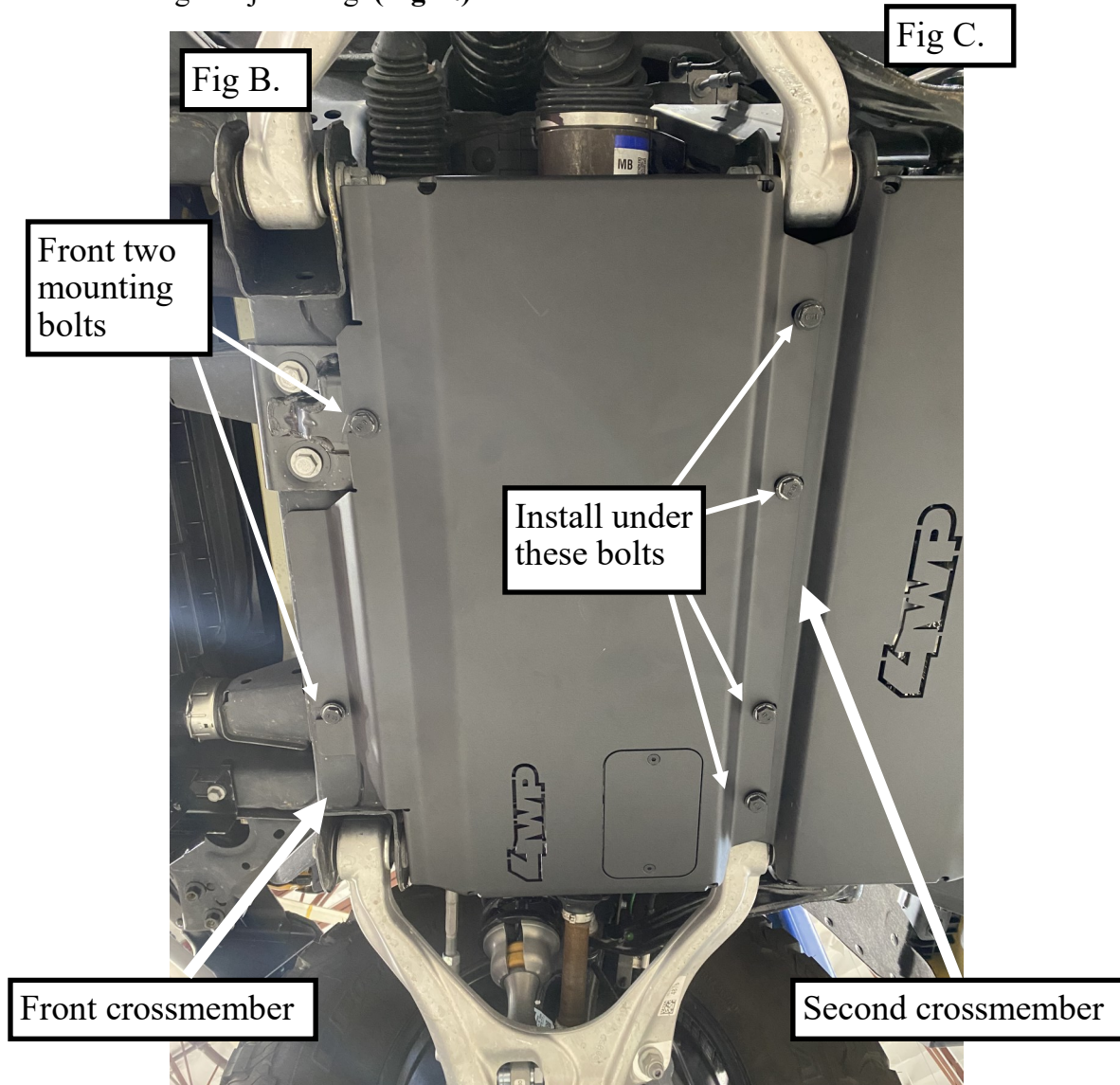

For Technical Support/Warranty Information please call 800-776-0767 EXT 1317

Smittybilt, 400 W Artesia, Compton, CA 90220



Installation Instructions:

(Part # S/B61270W)
Engine Skid plate
2021+ BRONCO 2dr&4dr

- Step 5:** Reinstall the front skid plate under the two front mounting bolts, sandwiching the engine skid against the front crossmember. **(Fig C.)**
When satisfied with fitment, snug then torque supplied hardware to **36ft-lbs**, any remaining OE hardware torque to **27ft-lbs**. Recheck hardware after 100 miles.

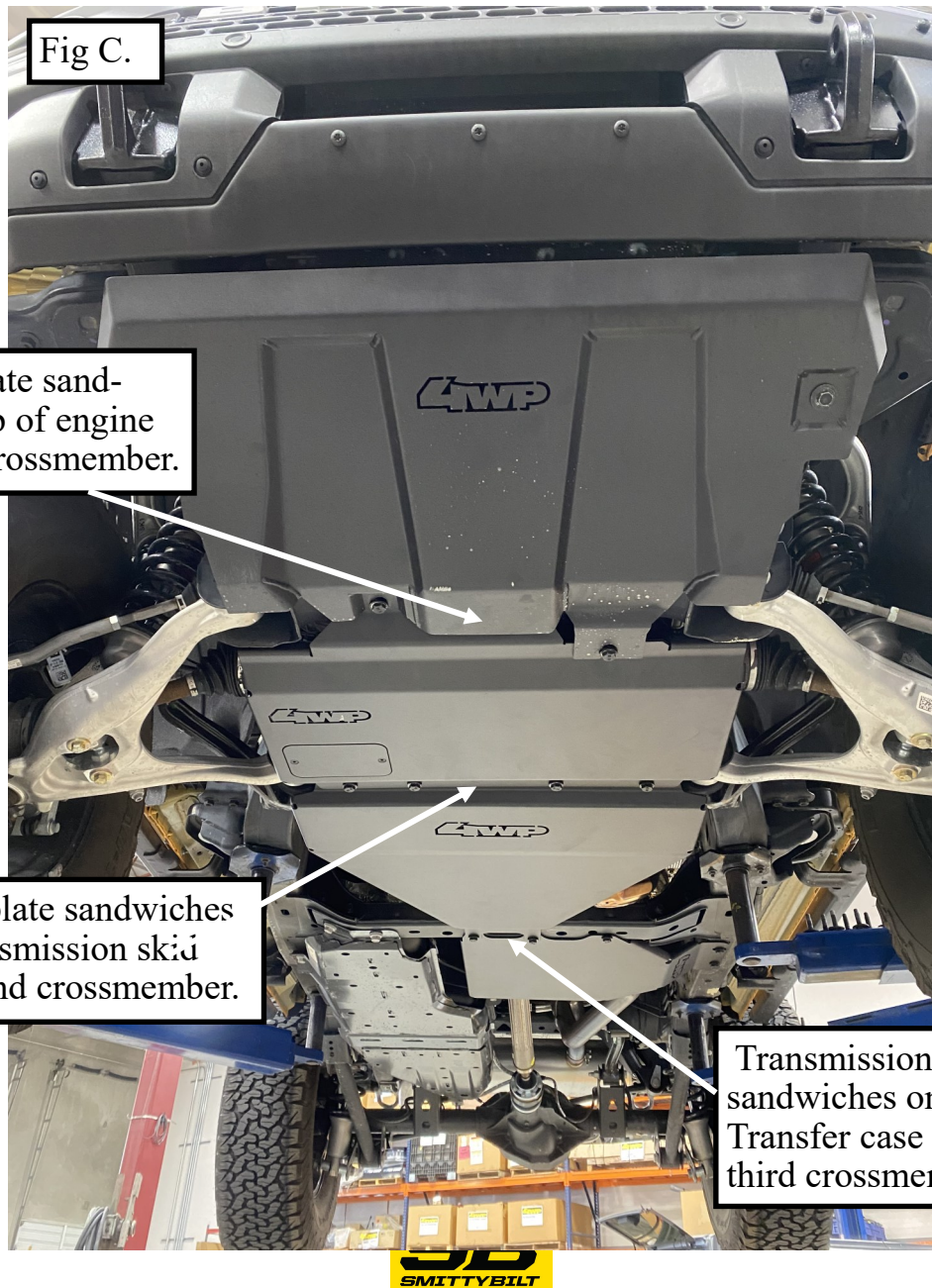

Fig C.

Front skid plate sandwiches on top of engine skid at first crossmember.

Engine skid plate sandwiches on top of transmission skid plate at second crossmember.

Transmission skid plate sandwiches on top of Transfer case skid plate at third crossmember.

For Technical Support/Warranty Information please call 800-776-0767 EXT 1317

Smittybilt, 400 W Artesia, Compton, CA 90220



Installation Instructions:

(Part # S/B61270W)
Engine Skid plate
2021+ BRONCO 2dr&4dr

Use this only as a guide for hardware without a called out torque specification in the instruction manual.

Bolt Torque and ID						
Decimal System			Metric System			
All Torques in Ft. Lbs. Maximums						
Bolt Size	Grade 5	Grade8	Bolt Size	Class 9.8	Class 10.9	Class 12.9
5/16	15	20	M6	5	9	12
3/8	30	45	M8	18	23	27
7/16	45	60	M10	32	45	50
1/2	65	90	M12	55	75	90
9/16	95	130	M14	85	120	145
5/8	135	175	M16	130	165	210
3/4	185	280	M18	170	240	290

1/2-13x1.75 HHCS

Grade 5 Grade 8
(No. of Marks + 2)

D T L X

G = Grade (Bolt Strength)
D = Nominal Diameter (Inches)
T = Thread Count (Threads per Inch)
L = Length (Inches)
X = Description (Hex Head Cap Screw)

M12-1.25x50 HHCS

D T L X

P = Property Class (Bolt Strength)
D = Nominal Diameter (Millimeters)
T = Thread Pitch (Thread Width, mm)
L = Length (Millimeters)
X = Description (Hex Head Cap Screw)

NOTE: Ford recommended maximum torque for 2021+ Bronco, OE 10mm threaded frame mounting holes is 50nm (**36.8ft-lbs**)



For Technical Support/Warranty Information please call 800-776-0767 EXT 1317

Smittybilt, 400 W Artesia, Compton, CA 90220



Installation Instructions:

(Part # S/B61270W)
Engine Skid plate
 2021+ BRONCO 2dr&4dr

Product cleaning and maintenance instructions

Stainless Steel Finish – Aluminum polish may be used to polish small scratches and scuffs on the finish. Mild soap, window or glass cleaner may be used to clean the finish. Dual state powder coat finish – Mild soap, window or glass cleaner may be used to clean the finish. In order to protect the finish, you may wax your product on a regular basis with pure carnauba automotive wax. Do not use any types of soap, polish or was that contains abrasive that could damage the finish. Textured coated finishes should be cleaned with a mild soap on a damp sponge. Do not apply polish or was that requires to be removed by means of buffing. This type of wax is commonly used at car wash facilities. Chrome Finish – Mild soap, window or glass cleaner may be used to clean the finish. In order to protect the finish, you should wax your product on a regular basis with pure carnauba automotive wax. Do not use any types of soap, polish or was that contains abrasive that could damage the finish.

Limited Warranties

Smittybilt's products are covered under the following limited warranties only. Note that the duration of the limited warranty differs according to the material and finish of the product purchased. Subject to the duration and conditions of the limited warranty stated below, Smittybilt warrants to the original retail purchaser that its products are free from defects in material and workmanship. All other warranties and representations express or implied, are hereby disclaimed, including fitness for merchantability and buyer's intended use or purpose. All parts are sold "AS IS" except for the limited warranties granted herein. Buyer assumes all risks as to the selection, suitability and performance of all goods and products selected. This limited warranty does not cover damage or impairment in any part due to misuse, improper installation, accident or contact with on-road or off-road hazards, product modification, improper or inadequate cleaning and/or maintenance. Smittybilt is not responsible for items damaged during shipping. This warranty is not transferable from the original buyer. For the original Buyer to be eligible for the limited warranty coverage, the Buyer must provide proof of purchase. Smittybilt strongly recommends returning the warranty registration card.

Customer's remedy hereunder shall be limited only to repair or replacement (at Smittybilt's option) of any defective part(s) returned to Smittybilt at customer's expense. The determination of whether or not a returned part is defective or subject to coverage under the limited warranties stated herein shall be made at Smittybilt's sole discretion.

To assure product quality, Smittybilt reserves the right to change product design, material, specification and finishes without prior notice to customers. This limited warranty gives you specific legal rights and you may also have other rights, which may vary from state to state. Some states do not allow limitations on how long an implied warranty lasts, so the above limitations may not apply as to you. Also, some states do not allow the exclusion or limitation of incidental or consequential damages, so the above limitations or exclusions may not apply to you. Smittybilt reserves the right to discontinue product lines and substitute products or provide other remedies than those listed in this limited warranty for those discontinued products.

Warning

Rollover and other types of vehicle accidents may result in serious injury or death to you, your passengers and others sharing the road. Smittybilt accessories are decorative and are not intended to reduce or avoid injury or damage in the event of an accident. The weight and location of Smittybilt accessories may affect your vehicles' handling, stability and performance, creating an increased risk of accident or rollover. Before installing any accessory, check state laws and assure that the accessory will not obscure any lights or interfere with proper operation on your vehicle's safety equipment. Consult your owner's manual and the Smittybilt instructions, or additional safety information. Smittybilt products, nor the warnings contained herein, are not a substitute for your safe driving. Don't drink and drive, always use seat belts and don't drive faster than conditions permit.



WARNING: Cancer and Reproductive Harm
www.P65Warnings.ca.gov



For Technical Support/Warranty Information please call 800-776-0767 EXT 1317

Smittybilt, 400 W Artesia, Compton, CA 90220