



XRC and X2O Gen 2  
Winch mount  
amendment.

X2O (Gen 2)

**Step 1:** With the control box mount brackets attached to control box, place on the adapter bracket. Secure the back section with the included hardware. (Fig 1, 2)



(Fig 1)

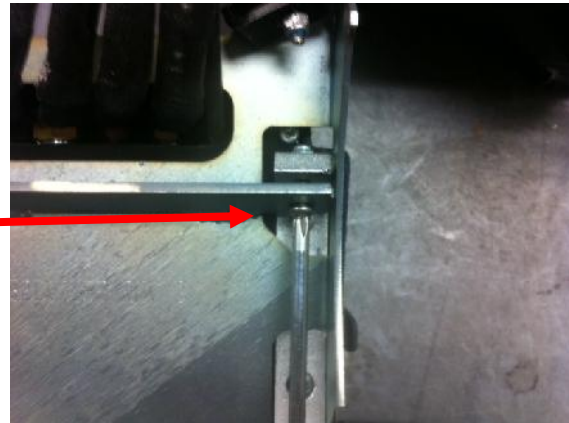

(Fig 2)

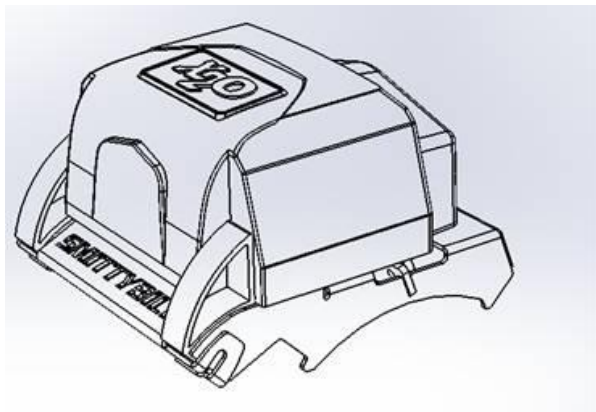

(Fig 3)

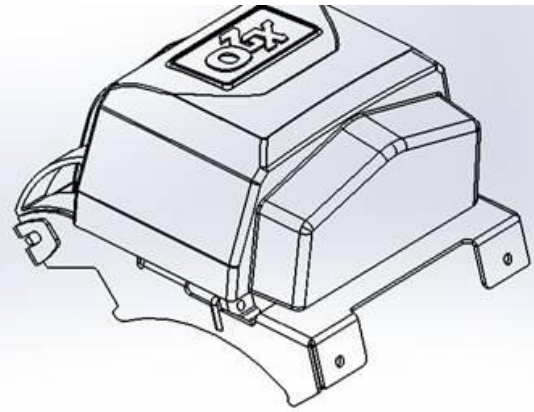

(Fig 4)

**Step 2:** If you have a steel cable winch, it will be easier to install if you free spool out the first 2 layers in order to give you room to secure the bracket to the winch. Place adapter bracket on winch tie-bars. The front of the bracket fits over the front tie-bar, secure the back of the bracket using the included hardware (L-brackets, screw, nut) that comes with the winch. (Fig 5-8)

Depending on how high or low your bumper is attached, it may also help ease of install if you loosen it.



XRC and X2O Gen 2  
Winch mount  
amendment.

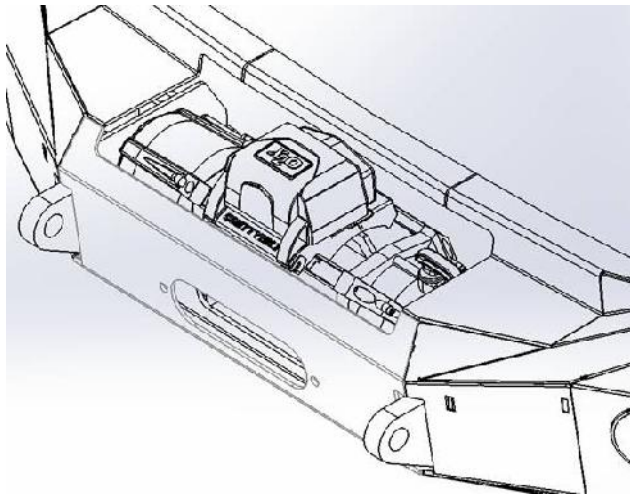

(Fig 5)



(Fig 6)

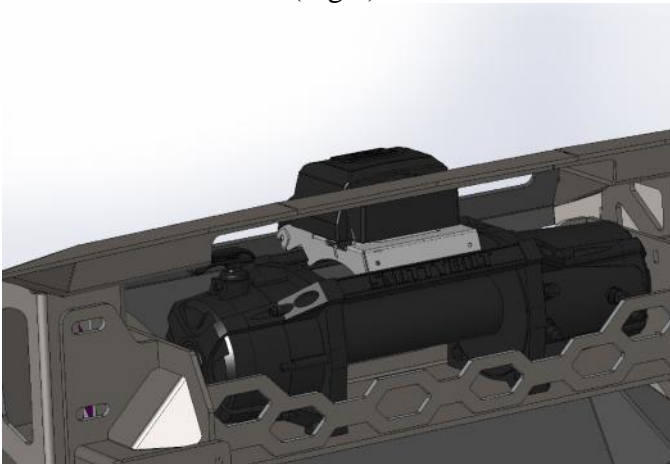

(Fig 7)



(Fig 8)

**Step 3:** Once bracket is firmly installed, proceed to install/connect winch wiring per manufacturers instructions. Check winch for proper wiring, when confirmed proceed to power in the cable and/or install synthetic rope.



## XRC and X2O Gen 2 Winch mount amendment.

### XRC (Gen 2)

**Step 1:** Remove screws from bottom of control box and secure adapter brackets to the bottom with same hardware. Note – the open side of the brackets face outward. (Fig 1, 2)



(Fig 1)

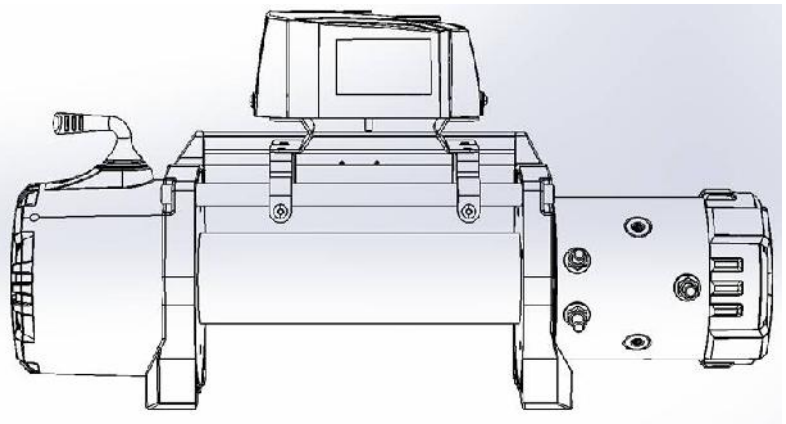

(Fig 2)

**Step 2:** Attach the control box mount brackets and spacers (using included hardware) to previously installed adapter brackets.

**Step 3:** If you have a steel cable winch, it will be easier to install if you free spool out the first 2 layers in order to give you room to secure the bracket to the winch. Place winch brackets on winch tie-bars per winch instructions. (Fig 3, 4, 5)



(Fig 3)

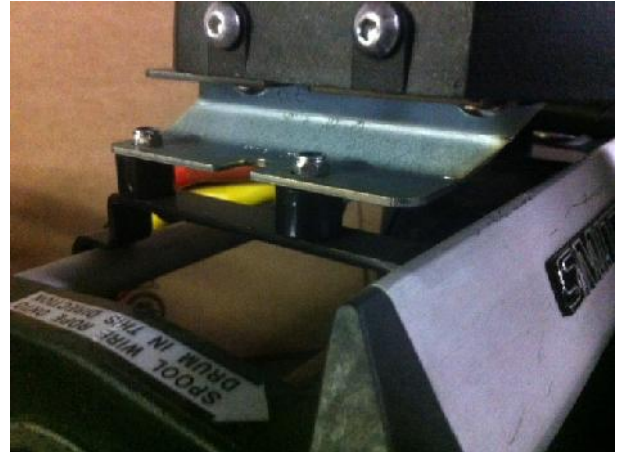

(Fig 4)



XRC and X2O Gen 2  
Winch mount  
amendment.

---

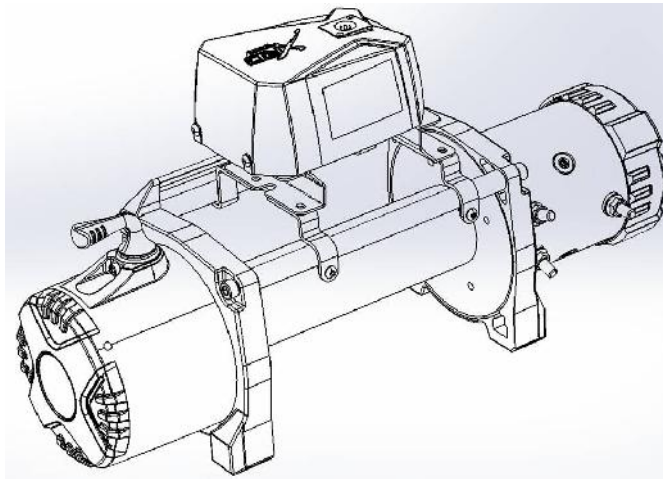

(Fig 5)

**Step 4:** Once bracket is firmly installed, proceed to install/connect winch wiring per manufacturers instructions. Check winch for proper wiring, when confirmed proceed to power in the cable and/or install synthetic rope.

---