

Installation Instructions



16-20 Toyota Tacoma Rock Sliders
Part # S/B61648W



For Technical Support / Warranty Information please call 800-776-0767 EXT 1317
or Email info@smittybilt.com

Introduction

Thank you for choosing Smittybilt accessories for your Toyota Tacoma. If you would like to view our full range of available accessories, please visit us at www.smittybilt.com



Toyota® and Tacoma® are registered trademarks of Toyota Motor Corporation.

Important Notes Before Starting



IMPORTANT NOTE

Carefully read through this entire instruction manual thoroughly before attempting to install this part.

The following tools will be required to complete the installation of this part:

TOOLS REQUIRED

Metric Socket & Wrench Set

Torque Wrench

Medium Strength Threadlocker



WARNING

Serious injury can occur when working on vehicles alone.

When possible, work with another person to reduce risk of injury from strain or other dangers that can occur when working alone.



For Technical Support / Warranty Information please call 800-776-0767 EXT 1317
or Email info@smittybilt.com

Box Contents

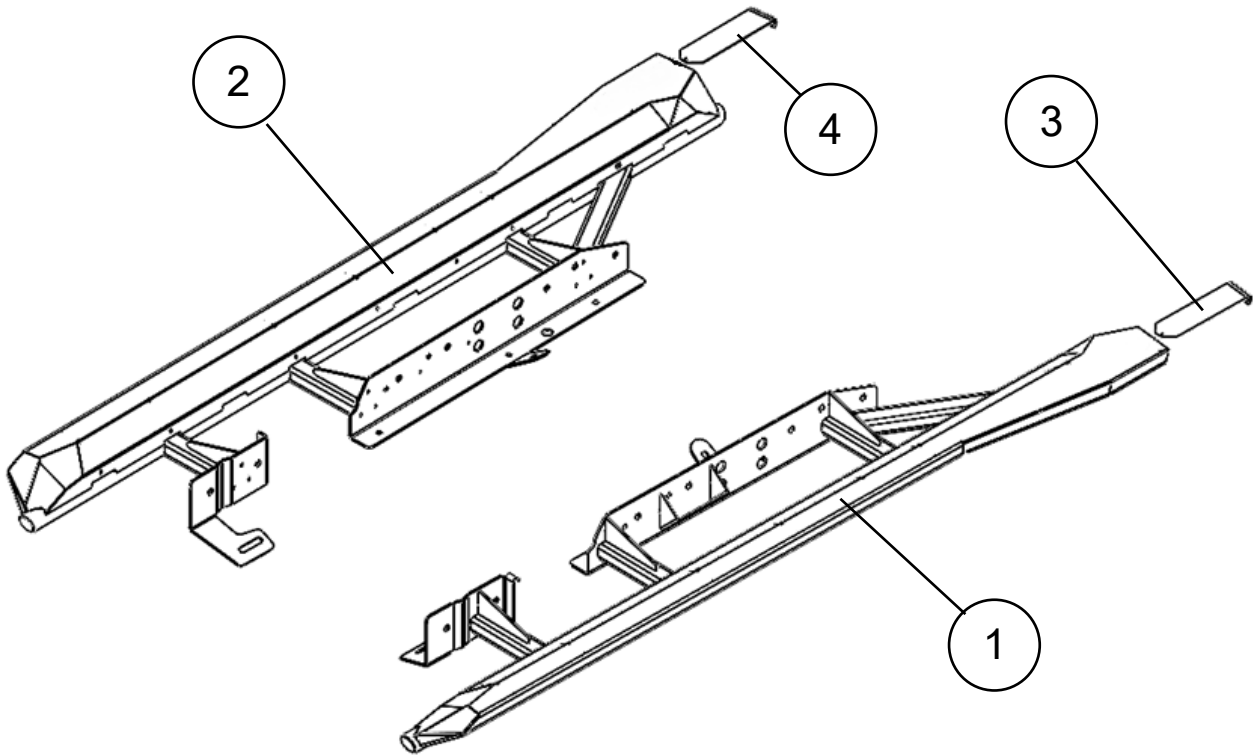

SB61648W BOX CONTENTS

ITEM NO.	PART NO.	DESCRIPTION	QTY
1	84-1039SO101-SB	TACOMA SLIDER - DRIVER ASSEMBLY	1
2	84-1039SO102-SB	TACOMA SLIDER - PASSENGER ASSEMBLY	1
3	102-1039SO101K-SB	TACOMA SLIDER - REAR LOGO BACK - DRIVER	1
4	102-1039SO102K-SB	TACOMA SLIDER - REAR LOGO BACK - PASSENGER	1
(pg3)	61648-01	TACOMA SLIDER - DRIVER HARDWARE	1
(pg4)	61648-02	TACOMA SLIDER - PASSENGER HARDWARE	1
(pg5)	61648-03	TACOMA SLIDER - RAMPED SPACER PACK	1
(pg5)	61648-04	TACOMA SLIDER-ROCK LIGHT MOUNT BRACKET ASSEMBLY	1
(pg5)	61648-05	TACOMA SLIDER - BRAKELINE PROTECTION	1
(pg5)	61648-06	TACOMA SLIDER - HD MOUNTING KIT	1



For Technical Support / Warranty Information please call 800-776-0767 EXT 1317
or Email info@smittybilt.com

Hardware Packs

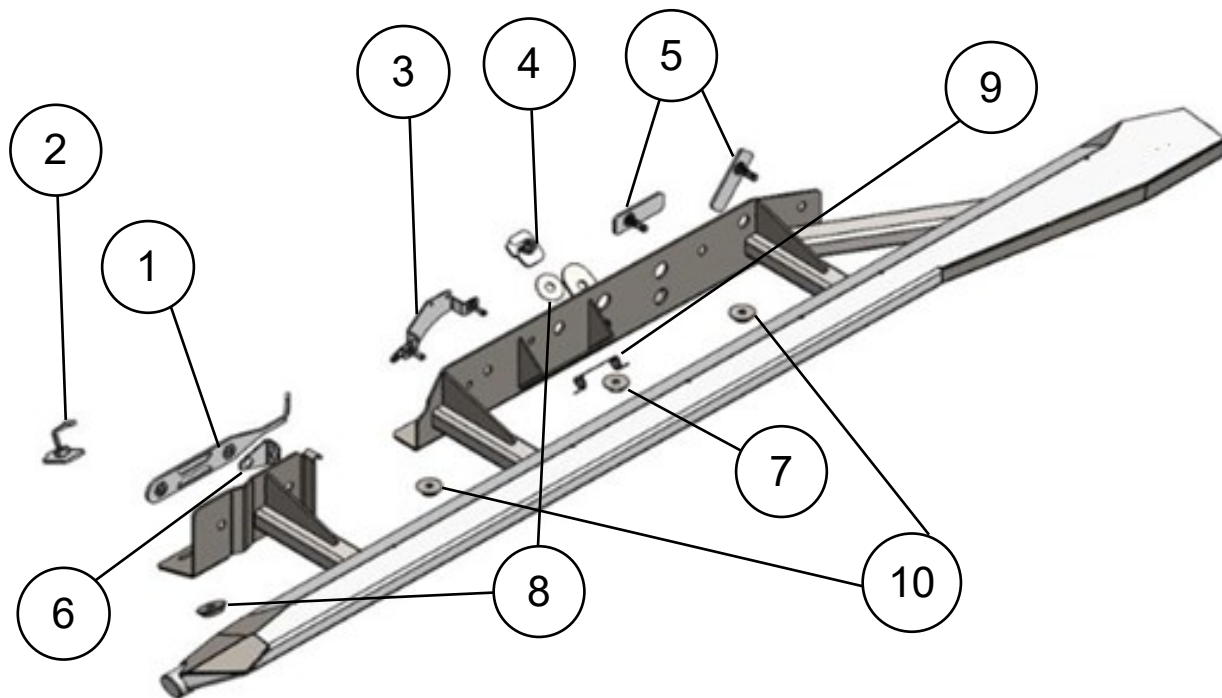

61648-01 TACOMA SLIDER - DRIVER HARDWARE

ITEM NO.	PART NO.	DESCRIPTION	QTY
1	84-1039SO103	TACOMA SLIDER - NUT PLATE 1 ASSEMBLY	1
2	84-1039SO104	TACOMA SLIDER - NUT PLATE 2 ASSEMBLY - DRIVER	1
3	84-1039SO105	TACOMA SLIDER - DRIVER MODULE BRKT ASSEMBLY	1
4	84-1039SO106	TACOMA SLIDER - NUT PLATE 3 ASSEMBLY	1
5	84-1039SO108	TACOMA SLIDER - BOLT PLATE 2 ASSEMBLY	2
6	84-1039SO101AD	TACOMA SLIDER - FRONT FRAME MNT SPACER	1
-	71-140352001000	M14X2X35 HHCS GR10.9 CZ	4
-	97310A118	M14 OVERSIZED WSHR CZ	2
-	97310A116	M10 OVERSIZED WSHR CZ	2
-	94645A220	M10X1.5 NYLOCK GR10 CZ	2
-	71-100351251000	M10X1.25X35 HHCS GR10.9 CZ	1
-	97310A117	M12 OVERSIZED WSHR CZ	2
-	94645A229	M12X1.5 NYLOCK GR10CZ	2
-	91263A464	M6X1X18 FHCS GR12.9 CZ	3



For Technical Support / Warranty Information please call 800-776-0767 EXT 1317
or Email info@smittybilt.com

Hardware Packs

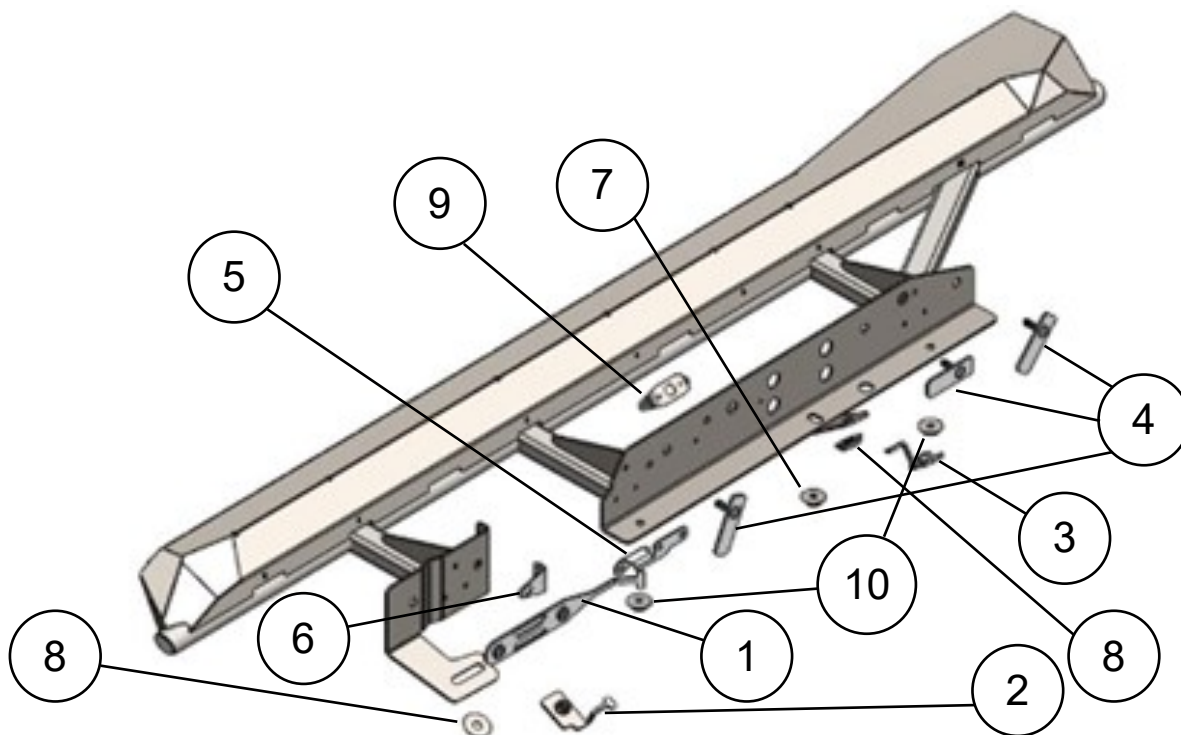

61648-02 TACOMA SLIDER - PASSENGER HARDWARE

ITEM NO.	PART NO.	DESCRIPTION	QTY
1	84-1039SO103	TACOMA SLIDER - NUT PLATE 1 ASSEMBLY	1
2	84-1039SO109	TACOMA SLIDER - NUT PLATE 2 ASSEMBLY - PASSENGER	1
3	84-1039SO106	TACOMA SLIDER - NUT PLATE 3 ASSEMBLY	1
4	84-1039SO108	TACOMA SLIDER - BOLT PLATE 2 ASSEMBLY	3
5	84-1039SO102W	TACOMA SLIDER - PASSENGER ELECTRICAL BRACKET	1
6	84-1039SO101AD	TACOMA SLIDER - FRONT FRAME MNT SPACER	1
-	71-140352001000	M14X2X35 HHCS GR10.9 CZ	4
-	97310A118	M14 OVERSIZED WSHR CZ	2
-	71-080251251000	M8X1.5X25 HHCS GR10.9 CZ	2
-	91166A270	M8 FLAT WSHR GR8.8 CZ	4
-	94645A210	M8X1.5 NYLOCK GR10 CZ	3
-	97310A117	M12 OVERSIZED WSHR CZ	3
-	94645A229	M12X1.5 NYLOCK GR10CZ	3
-	71-100351251000	M10X1.25X35 HHCS GR10.9 CZ	1
-	91263A464	M6X1X18 FHCS GR12.9 CZ	3



For Technical Support / Warranty Information please call 800-776-0767 EXT 1317
or Email info@smittybilt.com

Hardware Packs

61648-03 TACOMA SLIDER - RAMPED SPACER HARDWARE PACK

ITEM NO.	QTY	PART NO.	DESCRIPTION
7	2	84-44183	TACOMA SLIDER - RAMPED SPACER - M10
8	4	84-1039SO101AC	TACOMA SLIDER - RAMPED SPACER - M14

61648-04 TACOMA SLIDER - ROCK LIGHT MOUNT BRACKET ASSEMBLY HARDWARE PACK

ITEM NO.	QTY	PART NO.	DESCRIPTION
9	2	84-SB61249-27	TACOMA FB- ROCK LIGHT BRACKET
			M6 FLAT WSHR GR8.8 CZ
			M6X1X18 FHCS GR12.9 CZ
			M6X1 NYLOCK GR10 CZ

61648-05 TACOMA SLIDER - BRAKELINE PROTECTION HARDWARE PACK

DESCRIPTION			
ABRASION RESISTANT POLYURETHANE TUBING (NOT SHOWN)			
CABLE TIE, STANDARD, 11" LONG (NOT SHOWN)			

61648-06 TACOMA SLIDER - HD MOUNTING KIT HARDWARE PACK

ITEM NO.	QTY	PART NO.	DESCRIPTION
10	4	84-44183	TACOMA SLIDER - RAMPED SPACER - M10
			M10X1.25X35 HHCS GR10.9 CZ
			M10 OVERSIZED WSHR CZ
			M10X1.25 NYLOCK GR8 CZ



For Technical Support / Warranty Information please call 800-776-0767 EXT 1317
or Email info@smittybilt.com

Installation Instructions: Front Crossmember

! IMPORTANT NOTE

Carefully read through this entire instruction manual thoroughly before attempting to install this part.



WARNING

Chock all four wheels and make sure parking brake is engaged before starting this install. Failure to do so could result in serious injury.

Step 1: Check Box Contents

Open the box containing your Toyota Tacoma Sliders, check all parts against the Bill of Materials outlined in the first pages of these instructions.

If anything is missing, contact Smittybilt Support immediately.

Step 2: Remove OE Rub Rails

Remove any OE rub rails or running boards. Consult your owner's manual if needed.



Step 3: Nut Plate Installation

Starting on the driver side of the vehicle, install **PN:1039SO104 (Nut Plate 2 Assembly - Driver)** into the crossmember opening near the frame.

To do this, first insert the handle end into the large opening on the bottom of the crossmember (a) and then through the smaller opening on the rear of the crossmember (b).

Leave loose for now.

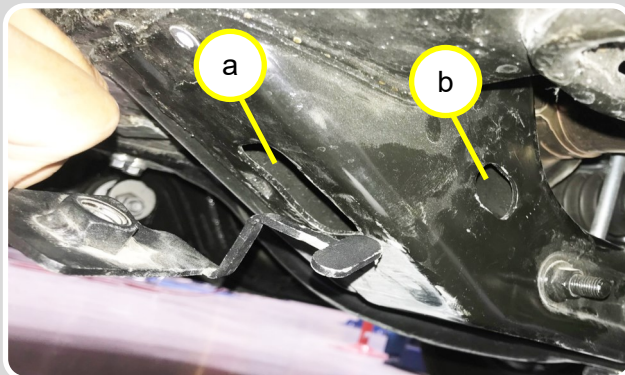

(Step 3 continued on next page)



For Technical Support / Warranty Information please call 800-776-0767 EXT 1317
or Email info@smittybilt.com

Installation Instructions: Frame



Step 3: (Continued)

Repeat step on passenger side to install **PN: 1039SO109 (Nut Plate 2 Assembly - Passenger)**.

It should look like this once complete:

(c) = Front Crossmember

(d) = Installed Nut Plate

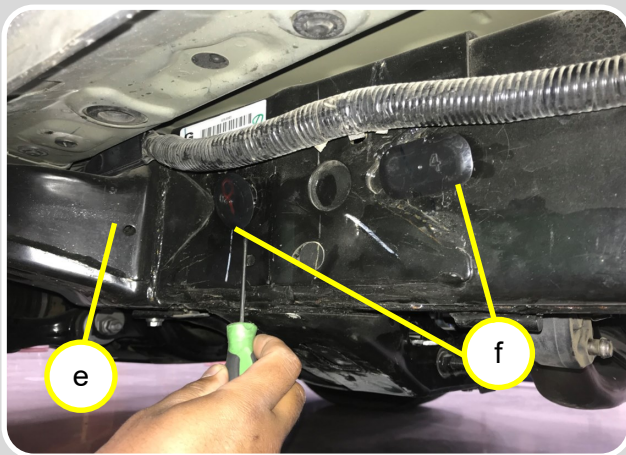

Step 4: Remove Plugs

Remove plugs (f) from Driver and Passenger outer side frame.

Front Driver side section shown at (e).

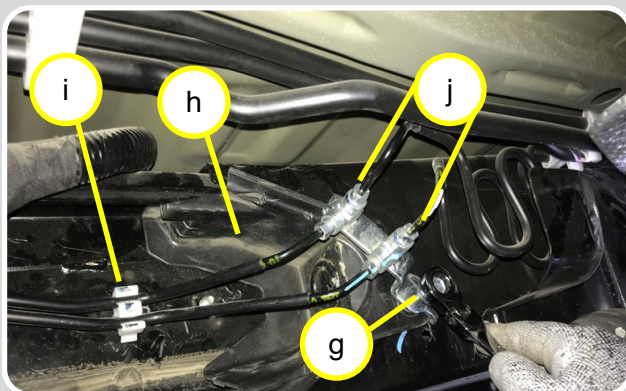

Step 5: Remove Brake Line Bracket

On the inner Driver side frame, remove the brake line bracket hardware (g) and plastic frame cover (h) using a **12mm socket**.

Save hardware for re-installation, un-clip brake line tab (i), and pull cover through under the brake line (j).

! IMPORTANT NOTE

Save Hardware for re-installation at Step 15.



For Technical Support / Warranty Information please call 800-776-0767 EXT 1317
or Email info@smittybilt.com

Installation Instructions: Frame

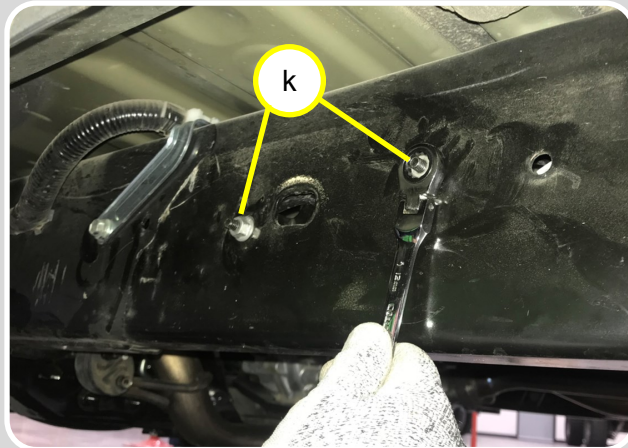

Step 6: Remove Fuel Pump Control Module Hardware

Looking at the center Driver side frame, unbolt the OE Fuel Pump Control Module hardware (*k*) using a **12mm wrench**. Do NOT disconnect it.

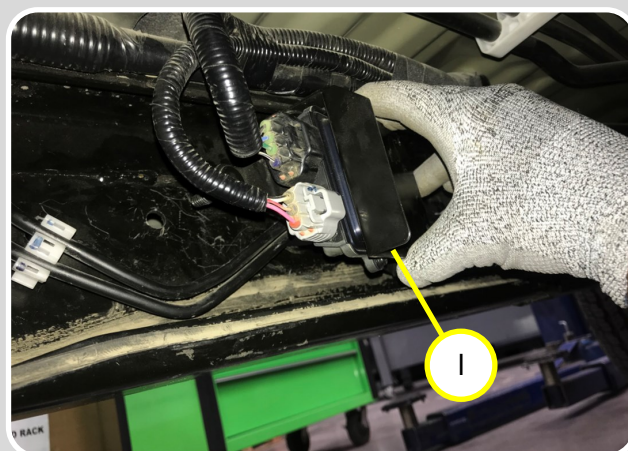

Once fuel pump module hardware is removed (*l*), hang module with a bungee cord or zip tie to support it. **DO NOT** let it hang from the wires.

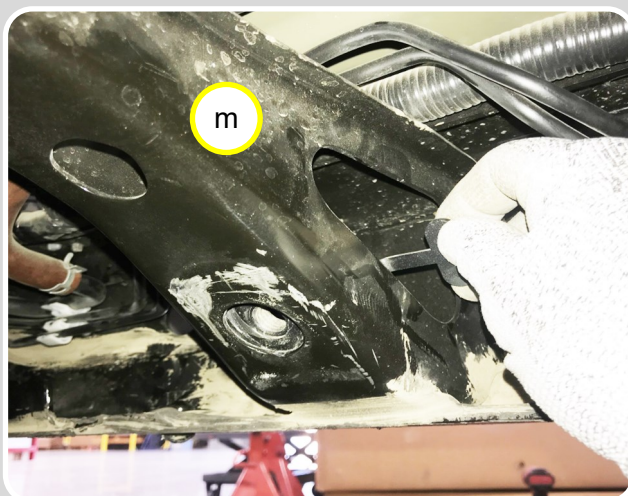

Step 7: Install Nut Plate 3

From the Driver side rear crossmember (*m*) frame install PN: **1039SO106 (Nut Plate 3)**.

Repeat the process on the Passenger side.



For Technical Support / Warranty Information please call 800-776-0767 EXT 1317
or Email info@smittybilt.com

Installation Instructions: Rear Crossmember

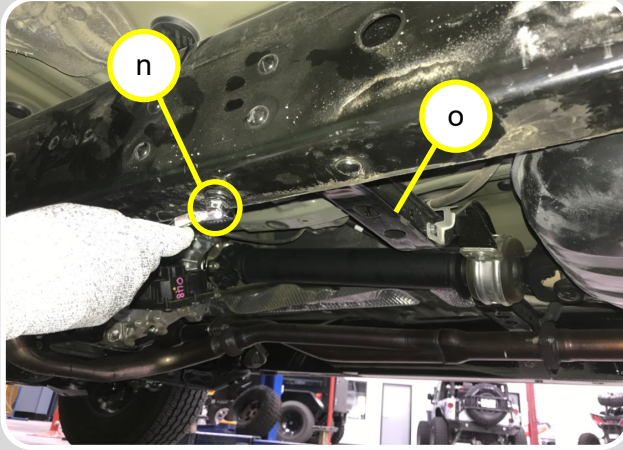

Step 8: Remove OE Bolt

On the Driver side rear crossmember (o), remove the M10 OE bolt (n) using a **14mm wrench**.

! IMPORTANT NOTE

AS YOU INSTALL SLIDERS, BOLT PLATES AND/OR BRACKETS, ENSURE BRAKE LINES AND/OR WIRES ARE CLEAR TO AVOID PINCHING HAZARD.

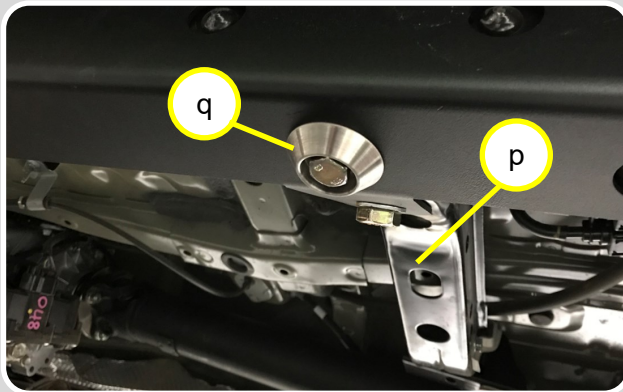

! IMPORTANT NOTE

This step will require 2 people.

Step 9: Install Ramped Spacer

Install slider to frame by aligning slider to driver side rear cross member nut. Install **M10 Ramped Spacer (PN: 84-44183)**, and **M10 bolt**. Add **Threadlocker** and tighten.

p = Driver side rear crossmember frame
q = Ramped spacer. Bolt and tighten



For Technical Support / Warranty Information please call 800-776-0767 EXT 1317
or Email info@smittybilt.com

Installation Instructions: Rear Crossmember

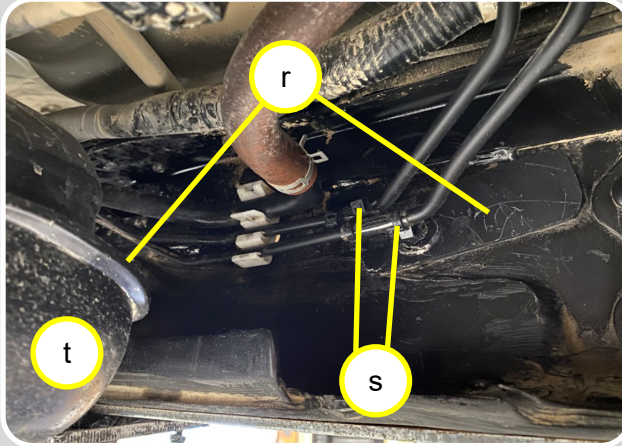

Step 10: Install Bolt Plates and Tubing

Working at the Driver side behind the rear frame, un-clip brake line bracket from frame and install the 2X PN: **84-1039SO108 Bolt Plate's** (*r*) from the inside out. Tighten using the **M12 oversized washers and nylock nuts** (*u*, bottom image).

Install the 2X **Abrasive Resistant Polyurethane Tubing** (from **61648-05, Brakeline Protection Hardware Pack**) to the 2X brake lines, at the section where the head of the bolt plate is closest to the brake line. To do this, slide the tubing onto the brake line and secure using cable ties on each end (*s*).

t = Gas Tank

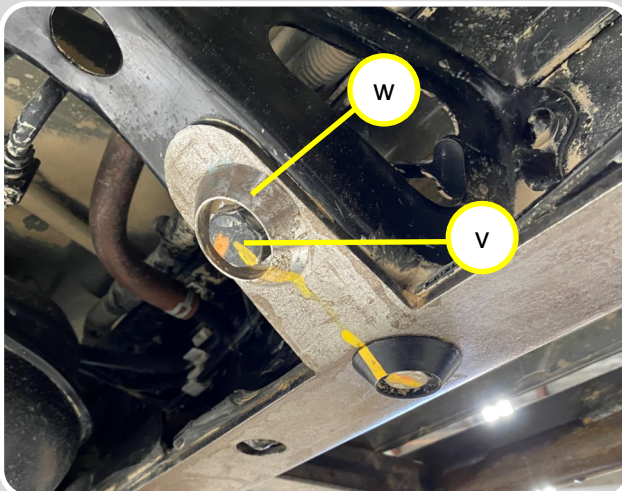
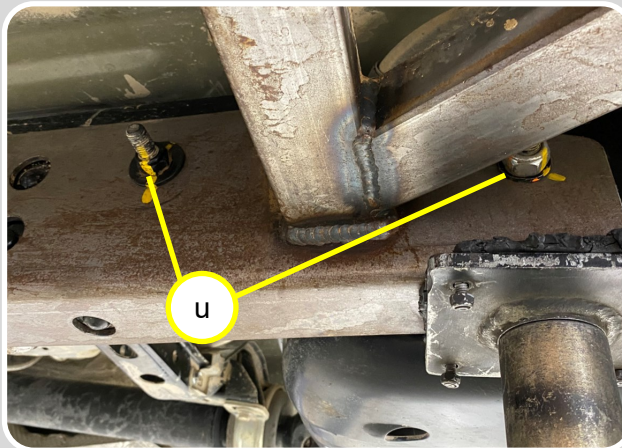

Step 11: Install Hardware to Nut Plate 3

Working at the Driver side rear crossmember, install **M14 Bolt** (*v*) and **M14 Ramped** (PN: **1039SO101AC**) (*w*) to PN: **84-1039SO106** (Nut Plate 3 Assembly).

Add **Threadlocker** and tighten bolt.



For Technical Support / Warranty Information please call 800-776-0767 EXT 1317
or Email info@smittybilt.com

Installation Instructions: Frame



Step 12: Install Driver Module Bracket

Using the OE hardware set aside in Step 6, install PN: **84-1039SO105 (Driver Module Bracket)** (x) to OE Fuel Pump Control Module.

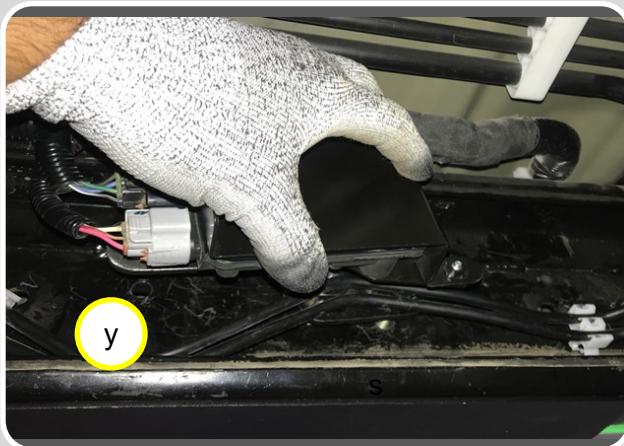

Step 13: Reinstall OE Fuel Pump Control Module

Install the Driver Module Bracket and Fuel Pump Control Module back into the OE position using 2X **M10 oversized washers** and 2X **M10 Nylock Nuts** (z).

(y shows inside section of Driver side frame)

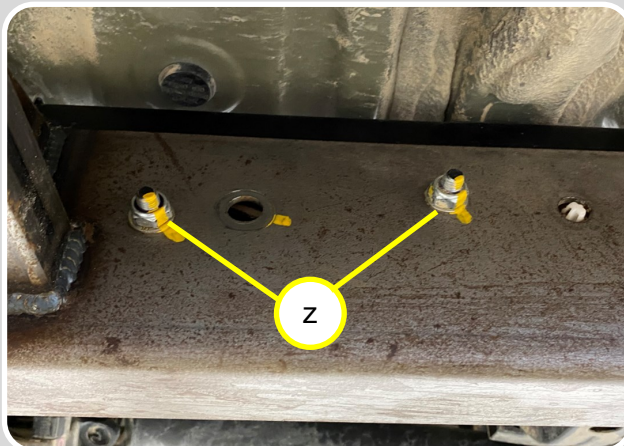

For Technical Support / Warranty Information please call 800-776-0767 EXT 1317
or Email info@smittybilt.com

Installation Instructions: Frame

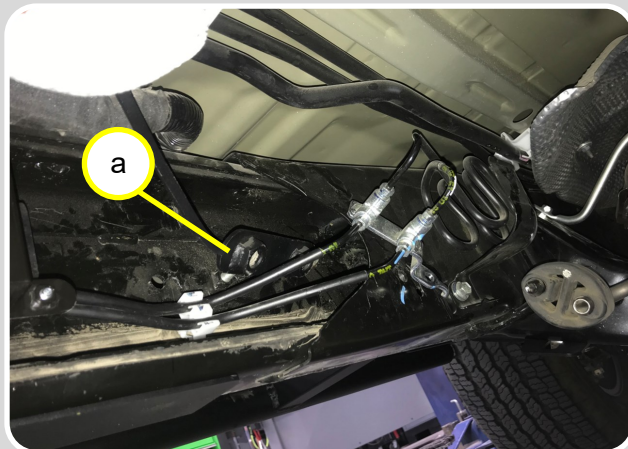

Step 14: Install Nut Plate 1 & Front Spacer

Install PN: **84-1039SO103 (Nut Plate 1 Assembly)** behind driver frame and brake line (a).

On the front side of frame install PN: **84-1039SO101AD (Front Frame Mount Spacer)** between the slider mounting bracket and frame as shown (b).

Use 2X **M14 bolts**, align distance to front of slider bracket and tighten (c).

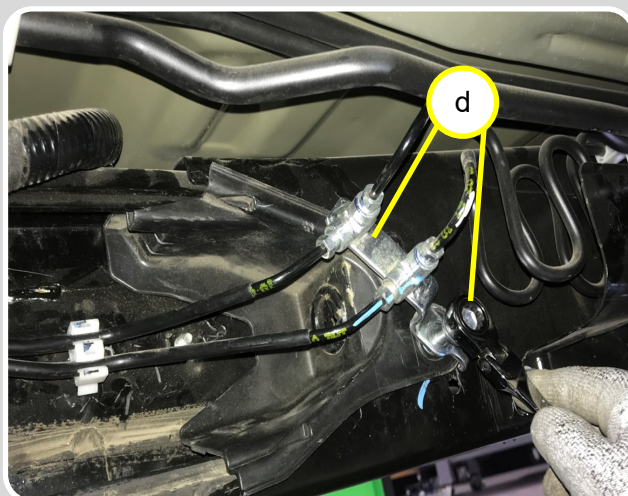
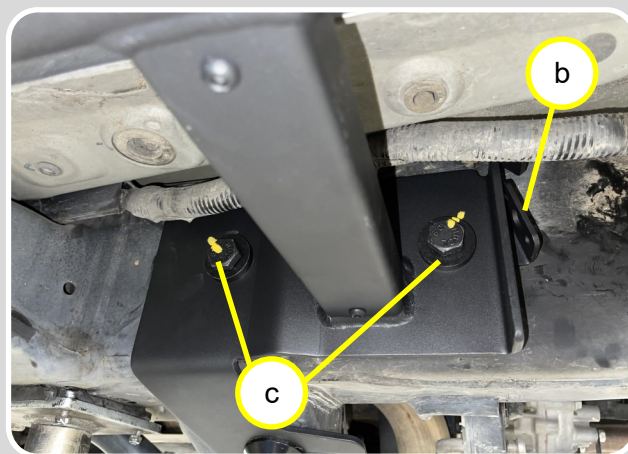

Step 15: Tighten Brake Line and Cover

At the Driver side front inside frame, re-secure brake line and plastic cover to frame using OE hardware previously removed at Step 5 and tighten (d).



For Technical Support / Warranty Information please call 800-776-0767 EXT 1317
or Email info@smittybilt.com

Installation Instructions: Front Crossmember

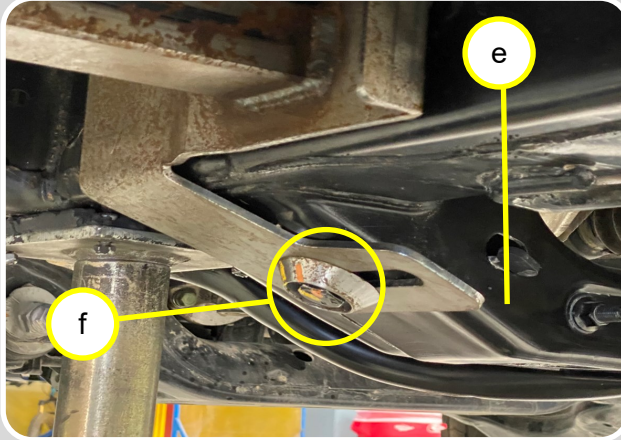

Step 16: Install Nut Plate 2

Align PN: 84-1039SO104 (Nut Plate 2 Assembly- Driver) to the Driver side front crossmember (*e*) and mount it using the M14X2X35 Hex bolt and M14 Ramped Spacer (*f*).

Apply **Threadlocker** and tighten.

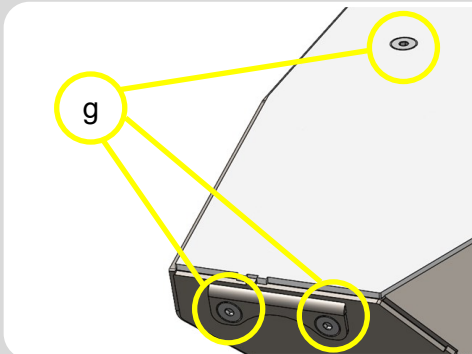

Step 17: Install Logo Backplate

Install PN: 1039SO101K (Rear Logo Back-Driver) to step using 3X M6 Flat Head Cap Screws (*g*) and tighten.

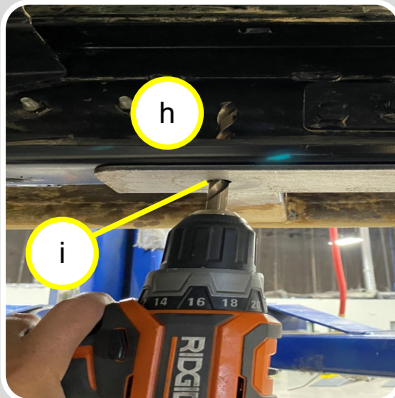

Step 18: Optional Step

To install the HD Mounting Kit (Optional): Locate the 2X bottom holes on the center mounting bracket of the slider. Drill the frame (*h*) through the mounting hole with a 7/16 drill bit (*i*).

Use the **61648-06 HD Mounting Kit Hardware Pack** (M10x1.25x35mm Hex Bolt, M10 Ramped Spacer, M10 Oversized Wshr, M10 Nylock nut) (*j*), and tighten.



For Technical Support / Warranty Information please call 800-776-0767 EXT 1317
or Email info@smittybilt.com

Installation Instructions: Passenger Junction Box

Step 19: Repeat Steps for Passenger Side Slider

For installation of **Passenger rock slider**, repeat steps 2–5, 7-11, 14-18 and the consecutive steps.

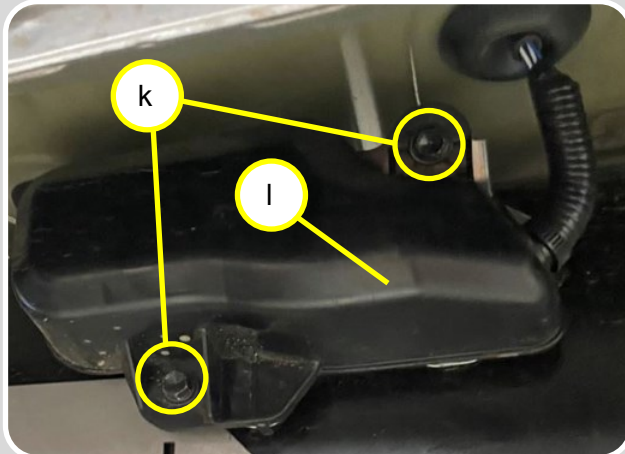

Step 20: Remove Electrical Box Cover

On the front frame Passenger side, use a **10mm wrench** and remove 2X bolts (*k*) on the Passenger junction box (*l*) electrical box cover.

! IMPORTANT NOTE

Cover and bolts will be re-used. Set aside.

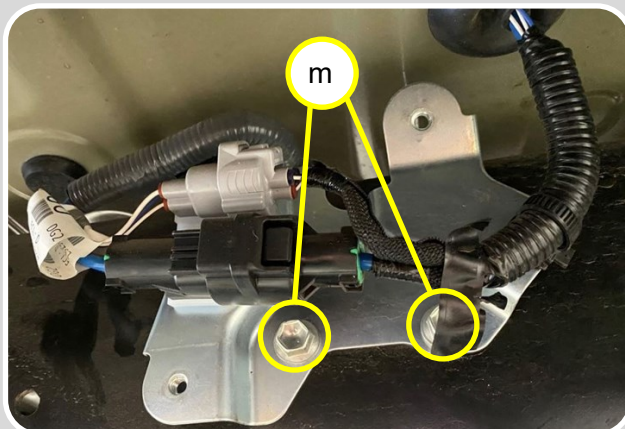

Step 21: Remove Passenger Junction Box Bracket

Remove 2X OE bolts (*m*) from frame and Passenger junction box bracket, using a **12mm wrench**. Remove Bracket.



For Technical Support / Warranty Information please call 800-776-0767 EXT 1317
or Email info@smittybilt.com

Installation Instructions: Passenger Junction Box

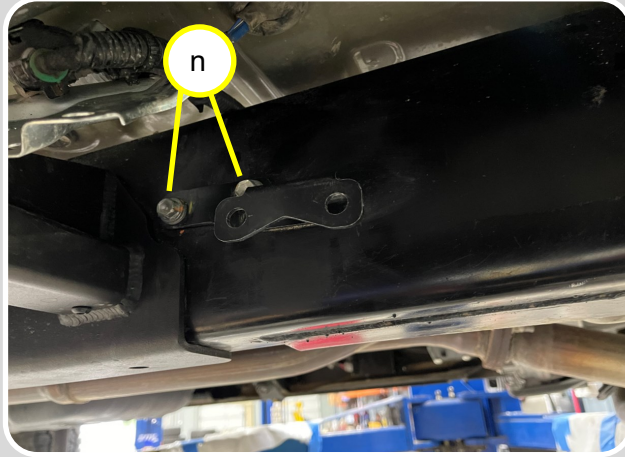

Step 22: Install Passenger Electrical Bracket

Re-use OE bolts (*n*) from Step 21 and install PN: 84-1039SO102W (Passenger Electrical Bracket) to Frame.

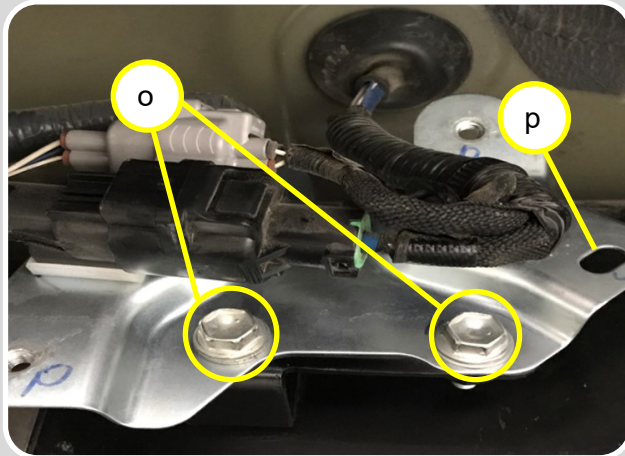

Step 23: Re-install Passenger Junction Box Bracket

Re-install Passenger Junction Box Bracket using 2X M8x1.25x25mm Hex Bolts and 2X M8 Flat Washers (*o*).

If junction wire box harness length is too short, cut zip tie and move where shown (*p*).



Step 24: Re-install Junction Box Cover

Re-Install Passenger Junction Box Cover to Bracket re-using OE Bolts set aside in step 20.



For Technical Support / Warranty Information please call 800-776-0767 EXT 1317
or Email info@smittybilt.com

Installation Instructions: Complete



Step 25: Tighten and Torque

Torque all bolts to spec, use the torque specification guide on page 18 for reference.

Your installation is now complete.



For Technical Support / Warranty Information please call 800-776-0767 EXT 1317
or Email info@smittybilt.com

Bolt Torque Specifications

Use this only as a guide for hardware without a called out torque specification in the instruction manual.

Bolt Torque and ID						
Decimal System			Metric System			
All Torques in Ft. Lbs. Maximums						
Bolt Size	Grade 5	Grade 8	Bolt Size	Class 9.8	Class 10.9	Class 12.9
5/16	15	20	M6	5	9	12
3/8	30	45	M8	18	23	27
7/16	45	60	M10	32	45	50
1/2	65	90	M12	55	75	90
9/16	95	130	M14	85	120	145
5/8	135	175	M16	130	165	210
3/4	185	280	M18	170	240	290

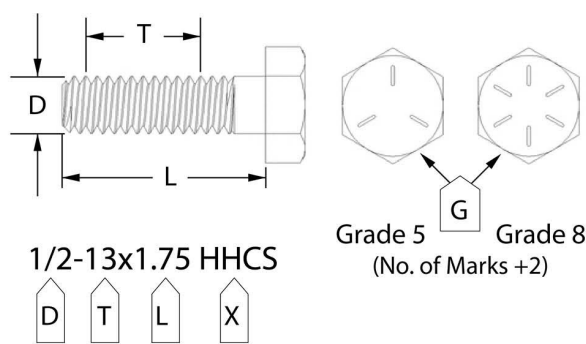

G= Grade (Bolt Strength)
D= Nominal Diameter (Inches)
T= Thread Count (Threads per Inch)
L= Length (Inches)
X= Description (Hex Head Cap Screw)

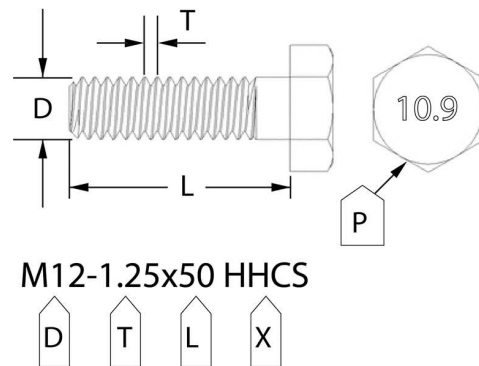

P= Property Class (Bolt Strength)
D= Nominal Diameter (Millimeters)
T= Thread Pitch (Thread Width, mm)
L= Length (Millimeters)
X= Description (Hex Head Cap Screw)



For Technical Support / Warranty Information please call 800-776-0767 EXT 1317
or Email info@smittybilt.com

Notes and Disclaimers

Product cleaning and maintenance instructions

Stainless Steel Finish – Aluminum polish may be used to polish small scratches and scuffs on the finish. Mild soap, window or glass cleaner may be used to clean the finish. Dual state powder coat finish – Mild soap, window or glass cleaner may be used to clean the finish. In order to protect the finish, you may wax your product on a regular basis with pure carnauba automotive wax. Do not use any types of soap, polish or wax that contains abrasive that could damage the finish. Textured coated finishes should be cleaned with a mild soap on a damp sponge. Do not apply polish or wax that requires to be removed by means of buffing. This type of wax is commonly used at car wash facilities. Chrome Finish – Mild soap, window or glass cleaner may be used to clean the finish. In order to protect the finish, you should wax your product on a regular basis with pure carnauba automotive wax. Do not use any types of soap, polish or wax that contains abrasive that could damage the finish.

Limited Warranties

Smittybilt's products are covered under the following limited warranties only. Note that the duration of the limited warranty differs according to the material and finish of the product purchased. Subject to the duration and conditions of the limited warranty stated below, Smittybilt warrants to the original retail purchaser that its products are free from defects in material and workmanship. All other warranties and representations express or implied, are hereby disclaimed, including fitness for merchantability and buyer's intended use or purpose. All parts are sold "AS IS" except for the limited warranties granted herein. Buyer assumes all risks as to the selection, suitability and performance of all goods and products selected. This limited warranty does not cover damage or impairment in any part due to misuse, improper installation, accident or contact with on-road or off-road hazards, product modification, improper or inadequate cleaning and/or maintenance. Smittybilt is not responsible for items damaged during shipping. This warranty is not transferable from the original buyer. For the original Buyer to be eligible for the limited warranty coverage, the Buyer must provide proof of purchase. Smittybilt strongly recommends returning the warranty registration card. Customer's remedy hereunder shall be limited only to repair or replacement (at Smittybilt's option) of any defective part(s) returned to Smittybilt at customer's expense. The determination of whether or not a returned part is defective or subject to coverage under the limited warranties stated herein shall be made at Smittybilt's sole discretion. To assure product quality, Smittybilt reserves the right to change product design, material, specification and finishes without prior notice to customers. This limited warranty gives you specific legal rights and you may also have other rights, which may vary from state to state. Some states do not allow limitations on how long an implied warranty lasts, so the above limitations may not apply as to you. Also, some states do not allow the exclusion or limitation of incidental or consequential damages, so the above limitations or exclusions may not apply to you. Smittybilt reserves the right to discontinue product lines and substitute products or provide other remedies than those listed in this limited warranty for those discontinued products.

Warning

Rollover and other types of vehicle accidents may result in serious injury or death to you, your passengers and others sharing the road. Smittybilt accessories are decorative and are not intended to reduce or avoid injury or damage in the event of an accident. The weight and location of Smittybilt accessories may affect your vehicles' handling, stability and performance, creating an increased risk of accident or rollover. Before installing any accessory, check state laws and assure that the accessory will not obscure any lights or interfere with proper operation on your vehicle's safety equipment. Consult your owner's manual and the Smittybilt instructions, or additional safety information. Smittybilt products, nor the warnings contained herein, are not a substitute for your safe driving. Don't drink and drive, always use seat belts and don't drive faster than conditions permit.



WARNING: Cancer and Reproductive Harm
www.P65Warnings.ca.gov



For Technical Support / Warranty Information please call 800-776-0767 EXT 1317
or Email info@smittybilt.com



For Technical Support / Warranty Information please call 800-776-0767 EXT 1317
or Email info@smittybilt.com