



# Installation Instructions:

(Part # SB77986)

XRC Rear Inner Fender

2018+ Jeep JL 2 and 4 Door

**NOTE: Carefully read entire instructions thoroughly before attempting to install this part.**

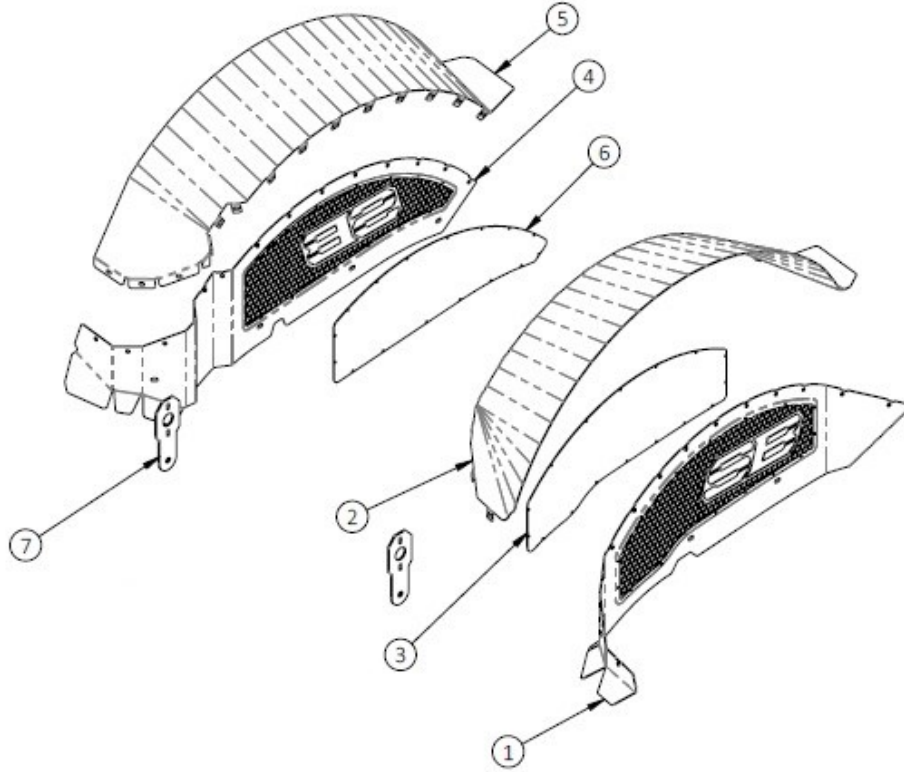

Parts Included	Qty	ID	Parts Included	Qty	ID
94-401LT101 JL REAR INNER FENDER - DS BACK PANEL	1	1	92949A146 M4(0.7) X 10MM BHCS SSTL	32	
94-401LT102 JL REAR INNER FENDER - DS TOP PANEL	1	2	91831A007 M4(0.7) NYLOCK NUT GR8.8 ZINC	32	
65-401LT103 JL REAR INNER FENDER - DS BACK PANEL INSERT	1	3	92949A833 M6(1.0) X 12MM BHXS SSTL	26	
94-401LT104 JL REAR INNER FENDER - PS BACK PANEL	1	4	97135A210 M6(1.0) NYLOCK NUT GR8.8 ZINC	26	
94-401LT105 JL REAR INNER FENDER - PS TOP PANNEL	1	5	92949A542 M6(1.0) X 25MM BHXS SSTL	7	
65-401LT106 JL REAR INNER FENDER - PS BACK PANEL INSERT	1	6	94850A129 M6(1.0) CLIP NUT GR8.8 ZINC	7	
94-401LT107 LIGHT MOUNT	2	7	98-77984-02 HARDWARE PACK	1	
90-8076 SPACER	7		M8(1.25) X 12MM HHCS GR8.8 BLACK ZINC	2	
90-44089 EDGE TRIM	1		M8 FL WSHR DIN 125 BLACK ZINC	4	
90-77984-01 HARDWARE PACK	1		M8(1.2) NYLOXK NUT GR8.8 BLACK ZINC	2	



## Installation Instructions:

(Part # SB77986)

*XRC Rear Inner Fender  
2018+ Jeep JL 2 and 4 Door*

### SUGGESTED TOOLS:

- Basic Mechanics Tool Set with Hex keys and Torx screwdrivers.

### BEFORE YOU BEGIN:

Park vehicle on a level surface and set the emergency brake. Wear eye protection beyond this point. If necessary, remove the rear tires to provide adequate access to the rear wheel-well area. Removing the tires may not be necessary on Jeeps with tall suspension lifts (as with our test fit Jeep in the following photos). If you do remove the tires, make sure the Jeep's rear axle is sitting firmly on jack stands, NOT the jack that was used to lift it.

Identify each piece from the kit and lay them out together. Determine which of the Inner Fender Panels go on the left (driver) side and right (passenger) side. The bead-rolled feature and the edge flanges stick out (away) from the back of the wheel well.

**NOTE:** *If your Jeep JL has the OEM Inner Fenders, you'll need to remove those before you can install the Smittybilt Rear Inner Fenders.*

### INSTALLATION:

**Step 1:** Starting with the left (driver) side components, first assemble the **DS BACK PANEL INSERT**, to the back side of the **DS BACK PANEL**, using the provided **M4** hardware. Make sure all of the holes line up by seating the flat insert properly into the bead-roll indentation (**Fig. A**).

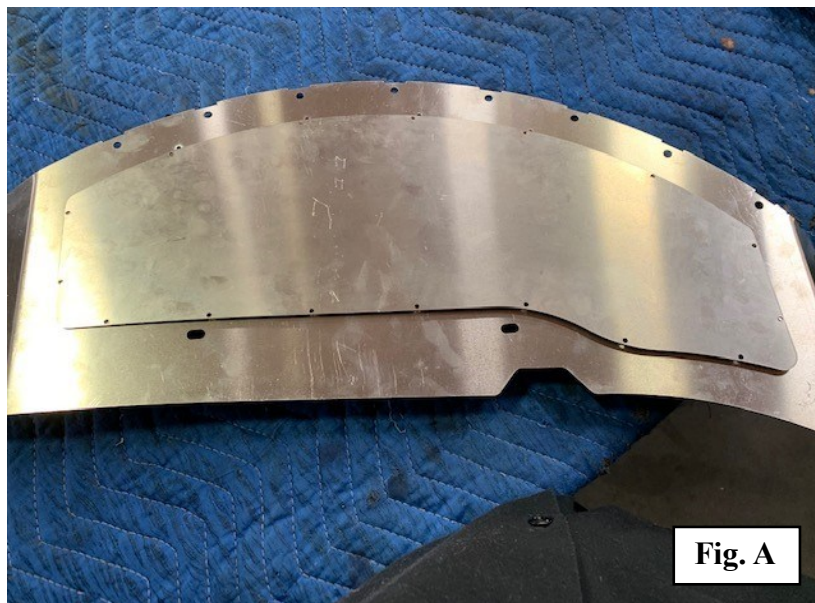



## Installation Instructions:

(Part # SB77986)

*XRC Rear Inner Fender  
2018+ Jeep JL 2 and 4 Door*

**Step 2:** Next, line up the last **DS TOP PANEL** mounting hole, to the last hole on the outer most flange on the **DS BACK PANEL**. Using the **M6** screws with the **M6 NYLON-INSERT LOCK NUTS**, loosely assemble the **DS TOP PANEL** to the **DS BACK PANEL** and **BACK PANEL INSERT** assembly from **Step 1 (Fig. B)**.

**NOTE:** *During the assembly, you will be bending the TOP PANEL and putting it into tension, so that it wraps around the top of the BACK PANEL.*



**Step 3:** With the front **DS TOP PANEL** now loosely attached to the **DS BACK PANEL**, slowly bend the **TOP PANEL** aligning the **TOP PANEL** mounting tabs, into the guide slots located along the top outer edge of the **BACK PANEL**. As you line up the hole for each tab, install the **M6** hardware and hand-tighten (**Fig. C**).







## Installation Instructions:

(Part # SB77986)  
*XRC Rear Inner Fender*  
*2018+ Jeep JL 2 and 4 Door*

**Step 4:** Once all of the **M4 & M6** hardware is installed and hand-tightened on the **TOP PANEL** and **BACK PANEL**, go back over the hardware and tighten with hand-tools for final assembly (**Fig. D**).



**Step 5:** Now, with the **DS REAR INNER FENDER** completely assembled, install the provided **EDGE TRIM**. Firmly press on the edge trim to seat the adhesive bead onto the edge of the sheet metal. (**Fig. E**) Trim the excess length, and save it for the **PS REAR INNER FENDER**.





## Installation Instructions:

(Part # SB77986)

*XRC Rear Inner Fender  
2018+ Jeep JL 2 and 4 Door*

**Step 6:** Now you are ready to start the installation on your JL. Install the **M6 SLIP-ON BARREL NUT** to the same holes used from the **OEM** fender liners. Be sure to attach the barrel nut, so that the barrel nut is facing away from you (**Fig. F & G**).

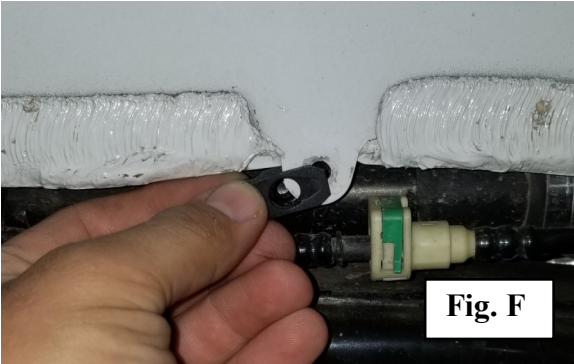

**Step 7:** For this next step, you may want the help of an additional person. While holding the **INNER FENDER** in the wheel well, place the **SPACER** behind the **BACK PANEL** and insert the **M6 BUTTON HEAD SCREW**, making sure the screw goes through the back panel, spacer, and hand-threading it into the clip-on barrel nut (**Fig. H**).

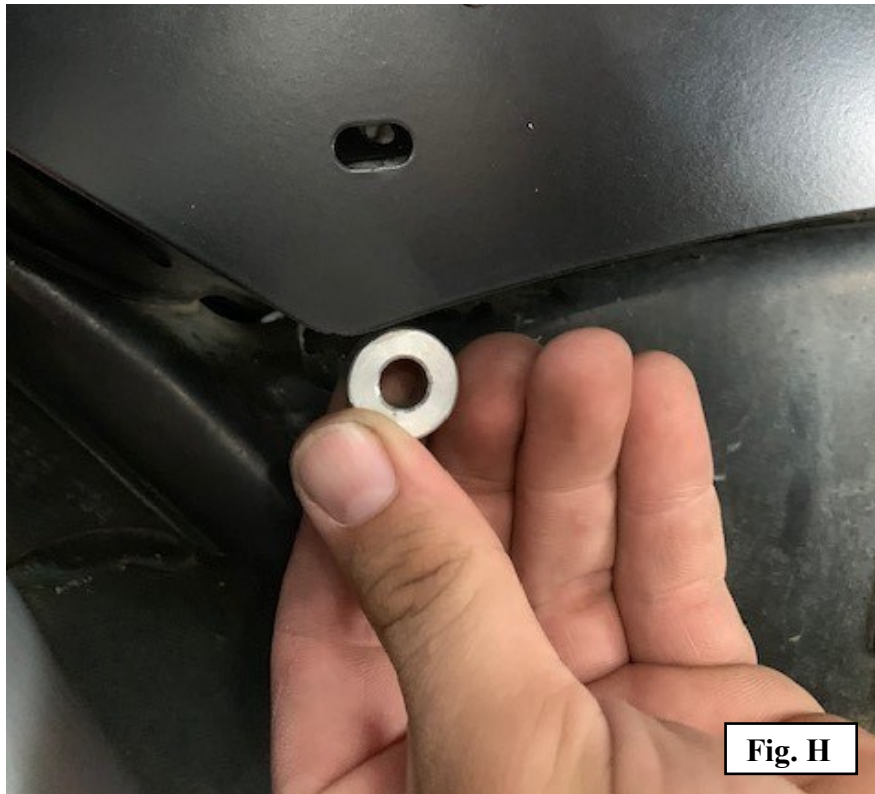

**Step 8:** Repeat this process for all the mounting hole locations.





## Installation Instructions:

(Part # SB77986)  
*XRC Rear Inner Fender*  
*2018+ Jeep JL 2 and 4 Door*

**Step 9:** Once the **REAR INNER FENDER** is in the wheel well, go back over the hardware and tighten with hand-tools for final installation (**Fig. I, J & K**).

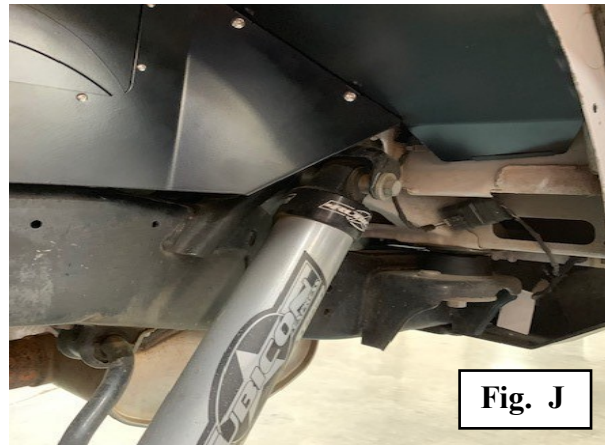
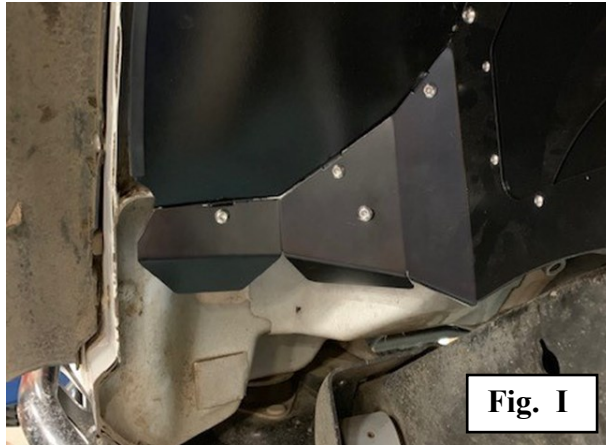

**Step 10:** Install the light and light mount assembly where best fits your application.



## Installation Instructions:

(Part # SB77986)  
*XRC Rear Inner Fender*  
*2018+ Jeep JL 2 and 4 Door*

**NOTE:** *The light mount is a universal fit, and is not necessary for the completion of your install.*

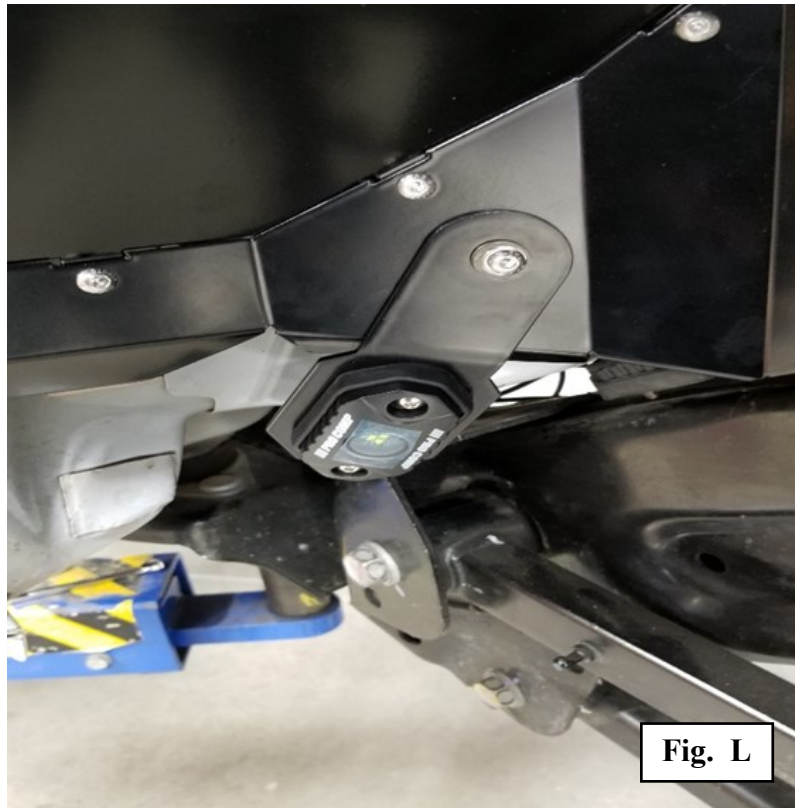

**Step 11:** Repeat steps 4-10 for the driver side.

**Step 12:** Congratulations! You have successfully installed your new Smittybilt product. Enjoy!



# Installation Instructions:

(Part # SB77986)

*XRC Rear Inner Fender  
2018+ Jeep JL 2 and 4 Door*

Use this only as a guide for hardware without a called out torque specification in the instruction manual.

Bolt Torque and ID						
Decimal System			Metric System			
All Torques in Ft. Lbs. Maximums						
Bolt Size	Grade 5	Grade8	Bolt Size	Class 9.8	Class 10.9	Class 12.9
5/16	15	20	M6	5	9	12
3/8	30	45	M8	18	23	27
7/16	45	60	M10	32	45	50
1/2	65	90	M12	55	75	90
9/16	95	130	M14	85	120	145
5/8	135	175	M16	130	165	210
3/4	185	280	M18	170	240	290

1/2-13x1.75 HHCS      **Grade 5    Grade 8**  
(No. of Marks + 2)

D   T   L   X

G = Grade (Bolt Strength)  
D = Nominal Diameter (Inches)  
T = Thread Count (Threads per Inch)  
L = Length (Inches)  
X = Description (Hex Head Cap Screw)

M12-1.25x50 HHCS

D   T   L   X

P = Property Class (Bolt Strength)  
D = Nominal Diameter (Millimeters)  
T = Thread Pitch (Thread Width, mm)  
L = Length (Millimeters)  
X = Description (Hex Head Cap Screw)





# Installation Instructions:

*(Part # SB77986)*  
*XRC Rear Inner Fender*  
*2018+ Jeep JL 2 and 4 Door*

## **Product cleaning and maintenance instructions**

Stainless Steel Finish – Aluminum polish may be used to polish small scratches and scuffs on the finish. Mild soap, window or glass cleaner may be used to clean the finish. Dual state powder coat finish – Mild soap, window or glass cleaner may be used to clean the finish. In order to protect the finish, you may wax your product on a regular basis with pure carnauba automotive wax. Do not use any types of soap, polish or was that contains abrasive that could damage the finish. Textured coated finishes should be cleaned with a mild soap on a damp sponge. Do not apply polish or was that requires to be removed by means of buffing. This type of wax is commonly used at car wash facilities. Chrome Finish – Mild soap, window or glass cleaner may be used to clean the finish. In order to protect the finish, you should wax your product on a regular basis with pure carnauba automotive wax. Do not use any types of soap, polish or was that contains abrasive that could damage the finish.

## **Limited Warranties**

Smittybilt's products are covered under the following limited warranties only. Note that the duration of the limited warranty differs according to the material and finish of the product purchased. Subject to the duration and conditions of the limited warranty stated below, Smittybilt warrants to the original retail purchaser that its products are free from defects in material and workmanship. All other warranties and representations express or implied, are hereby disclaimed, including fitness for merchantability and buyer's intended use or purpose. All parts are sold "AS IS" except for the limited warranties granted herein. Buyer assumes all risks as to the selection, suitability and performance of all goods and products selected. This limited warranty does not cover damage or impairment in any part due to misuse, improper installation, accident or contact with on-road or off-road hazards, product modification, improper or inadequate cleaning and/or maintenance. Smittybilt is not responsible for items damaged during shipping. This warranty is not transferable from the original buyer. For the original Buyer to be eligible for the limited warranty coverage, the Buyer must provide proof of purchase. Smittybilt strongly recommends returning the warranty registration card.

Customer's remedy hereunder shall be limited only to repair or replacement (at Smittybilt's option) of any defective part(s) returned to Smittybilt at customer's expense. The determination of whether or not a returned part is defective or subject to coverage under the limited warranties stated herein shall be made at Smittybilt's sole discretion.

To assure product quality, Smittybilt reserves the right to change product design, material, specification and finishes without prior notice to customers. This limited warranty gives you specific legal rights and you may also have other rights, which may vary from state to state. Some states do not allow limitations on how long an implied warranty lasts, so the above limitations may not apply as to you. Also, some states do not allow the exclusion or limitation of incidental or consequential damages, so the above limitations or exclusions may not apply to you. Smittybilt reserves the right to discontinue product lines and substitute products or provide other remedies than those listed in this limited warranty for those discontinued products.

## **Warning**

Rollover and other types of vehicle accidents may result in serious injury or death to you, your passengers and others sharing the road. Smittybilt accessories are decorative and are not intended to reduce or avoid injury or damage in the event of an accident. The weight and location of Smittybilt accessories may affect your vehicles' handling, stability and performance, creating an increased risk of accident or rollover. Before installing any accessory, check state laws and assure that the accessory will not obscure any lights or interfere with proper operation on your vehicle's safety equipment. Consult your owner's manual and the Smittybilt instructions, or additional safety information. Smittybilt products, nor the warnings contained herein, are not a substitute for your safe driving. Don't drink and drive, always use seat belts and don't drive faster than conditions permit.